

CULVERT NO. 430188

PROJECT REFERENCE NO.	SHEET NO.
BP14.R002	EC-13/CONST.5

**RS&H**  
8521 SIX FORKS ROAD, SUITE 400  
RALEIGH, NC 27615  
NC FIRM LICENSE No: F-0493

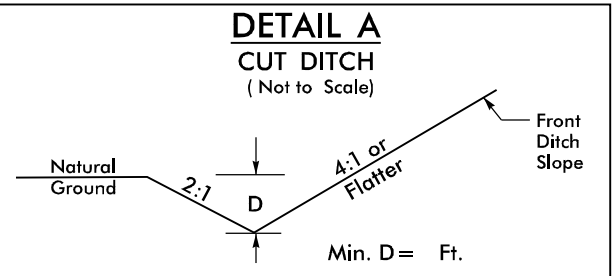
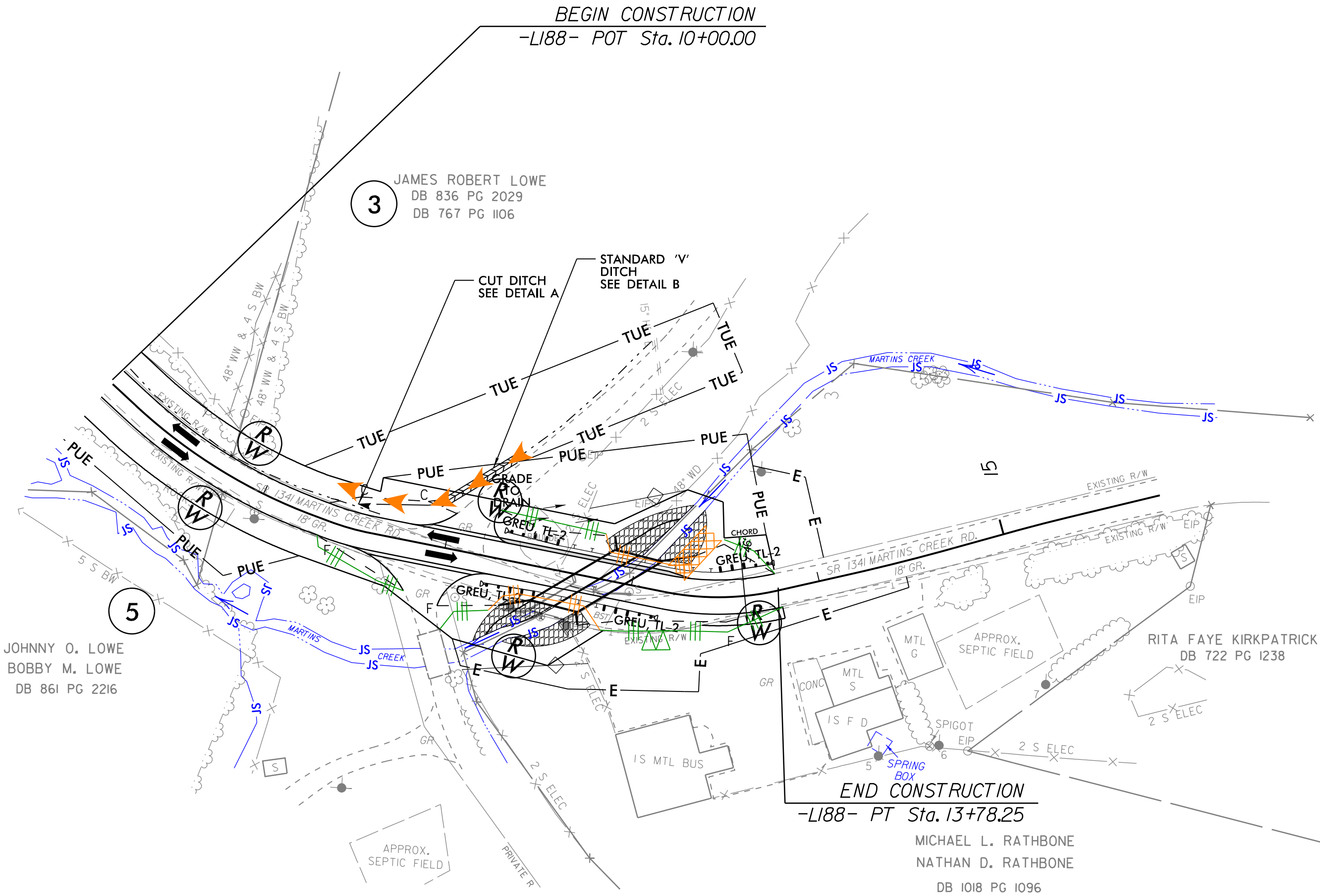
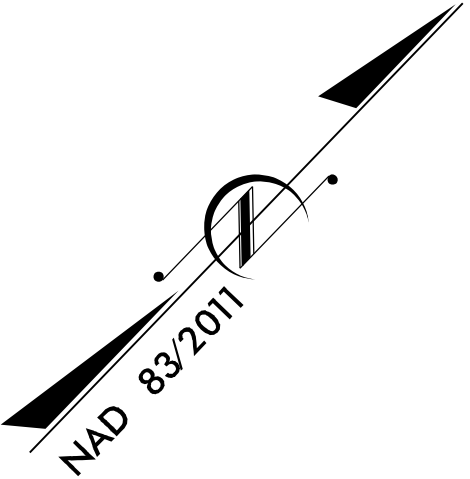

FROM -LI88- STA. 11+34 TO STA. 12+00 LT

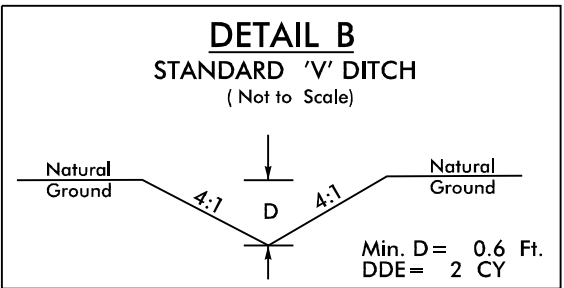

FROM -LI88- STA. 12+00 TO STA. 12+29 LT

NOTE: EXCELSIOR OR OTHER MESH TYPE NETTING IS NOT ALLOWED IN OR ON STREAM BANKS.

NOTES: ANY DEVIATION FROM OPTIONS GIVEN WILL REQUIRE PRIOR APPROVAL BY ENGINEER.

ADDITIONAL EROSION CONTROL DEVICES MAY NEED TO BE INSTALLED AS DIRECTED BY THE ENGINEER.